



M4 Bluetooth®
User Guide



© 2014 Neckmike USA

Table of Contents

Quick Start Guide	2
Neckmike Components	3
Proper Fitment of Earbud Speakers	3
Proper Fitment of Neckmike Microphone	5
M4 Bluetooth Unit Overview	6
M4 Bluetooth Unit Functions and Operation	
Basic Operation	9
Bluetooth Pairing	9
Pairing with a Mobile Phone	9
Using with a Mobile Phone	10
Pairing Two M4 Bluetooth Units	10
Using the M4 Bluetooth Unit Intercom	11
Pairing Additional M4 Bluetooth Units	12
Pairing with a GPS Navigation Device	14
Pairing with an MP3 Player	15
Mounting the M4 Bluetooth Unit	16
M4 Wireless Handlebar Remote	16
Support	18
Notifications	
Battery Warning	18
Declaration of Conformity- Bluetooth®	18
FCC Compliance	18
Copyright	19
IMPORTANT SAFETY INFORMATION	19
Limited Warranty	19

Thank you for choosing the Neckmike M4 Bluetooth communication system!

Neckmike enables communication and hearing protection in high noise environments with a unique and patented headset. Because Neckmike is a professional grade, military-derived product, please follow the instructions in this User Guide for best results.

--Proper fitment is essential to achieve good results--

Save this manual for future reference.

Quick Start Guide

Fitting the Neckmike Headset

• **Microphone Position.** The microphone cabinet must be in full contact with your neck skin to pick up your voice. It should be worn relatively high on the neck, 1-2" to the either side of your voice box. If the microphone is positioned too low on the neck, your voice may sound muffled. If it is positioned too close to your voice box (for example, on top of your voice box), your voice may sound slightly distorted.

• **Velcro Strap.** The Velcro keeper strap is used to maintain the position of the microphone against the neck at a comfortable tension. Once fitted, the excess strap material may be trimmed with scissors and discarded (otherwise it will flap in the wind while riding and create noise).

• **Neck Band.** The wire neck band may be gently bent along its radius every inch or two in the direction of the curve to reduce the overall diameter of the neck band, thereby providing a snugger fit against the neck if desired.

• **Ear Plug Sizing.**

The headset includes with multiple sizes of ear plugs:

Smallest	BLACK single flange
Small/Med	YELLOW double flange
Med/Large	RED/ORANGE double flange
Med/Large	GRAY triple flange (longer tip)

It is important to use the ear plug size which fits you best to achieve the maximum hearing protection and ease of listening.

• **Ear Plug Fitment.** Always lightly moisten the ear plugs prior to insertion to achieve a good acoustic seal (this is true of any silicone ear plug). A few drops of water applied from your fingers or "kissing" them first will do the trick. Install the earplugs by reaching over head and gently pull up and back on outer ear to the straighten ear canal.



With opposite hand, grasp the earplug stem and insert with a circular motion to form an airtight seal. When fitted correctly, it should sound as quiet as when you put your fingers in your ears.

Operating the M4 Bluetooth Unit

- **Battery Charge.** You must first charge the M4 unit battery and remote control prior to operation. (Please see detailed instructions).
- **Power On.** To turn the unit on, press and hold the On/Off button (marked with a motorcycle icon) for 5-7 seconds until the blue LED illuminates, then release.
- **Power Off.** To power off, press and hold the On/Off button for 6-8 seconds until the blue LED is constant, then release.
- **Volume Control.** Volume up is the lower of the two small volume buttons on the Bluetooth unit. On the remote control volume up is above volume down.
- **Bluetooth Intercom.** If you purchased a Neckmike M4 Bluetooth Twin Pack, the two Bluetooth units are already paired out of the box for intercom use. In fact, the A, B, and C channels are all paired with each other, so you can press any button (A, B, C) to open or close the intercom with the other unit (when the units are powered on). If you are in a larger group, the A, B, and C buttons would be used to connect between other Neckmike units in your group, after completing a one-time pairing process (see detailed instructions). The intercom normally opens within 3-5 seconds after pressing the appropriate button.
- **Pair with Phone.** To pair with your mobile phone (with the unit powered off), press and hold the On/Off button approximately 10 seconds until the LED flashes red and blue to indicate the unit is in pairing mode, then release. From your mobile phone, scan for nearby Bluetooth devices. The M4 will appear as "Motor Phone" in the phone menu. If you are prompted to enter a PIN, use 0000 (four zeros).

- **Using with a Phone.** Once you are paired with your phone, you can take calls and listen to stereo music from your phone. When you receive a call, a short press of the phone button (marked with a green phone icon) may be used to quickly answer the call, or it will automatically be picked up after three or four rings without pressing anything. A long button press is used to reject an incoming call. During an active call, you can hang up by pressing the phone button again. The phone button is also used to pause and play music from the phone, when not on an active call or intercom session.
- **Reset Button.** The small gray reset button may be used if you are having trouble connecting to other M4 units or to a mobile phone (this is usually caused by RF interference). Pressing the button will reset the unit and immediately power the unit off if it is turned on. Resetting the unit does not erase Bluetooth pairings made with mobile phones or other M4 units; however it will reset the volume to a lower preset level.

Other Notes

- **Coiled Extension Cable.** A coiled cable is used to connect between the headset and the M4 Bluetooth unit. It is made with inline filters to reduce the microphone sensitivity, as many riders tend to talk loudly while underway. Also, this cable ensures a positive connection to the Bluetooth unit, with a slightly longer 4 segment plug. The right-angled end goes into the M4 Bluetooth unit and the straight end to the Neckmike headset. This cable must be used at all times or the headset will not function properly.
- **No Helmet.** For use without a helmet, the M4 Bluetooth unit may be put into a jacket pocket, and the handlebar remote can be used to control all functions. Note that putting the M4 unit in a pocket will reduce the range of the Bluetooth intercom. Fitting the Neckmike headset



Neckmike Components

The Neckmike is comprised of several components, which are referenced in this User Guide (Image 1).

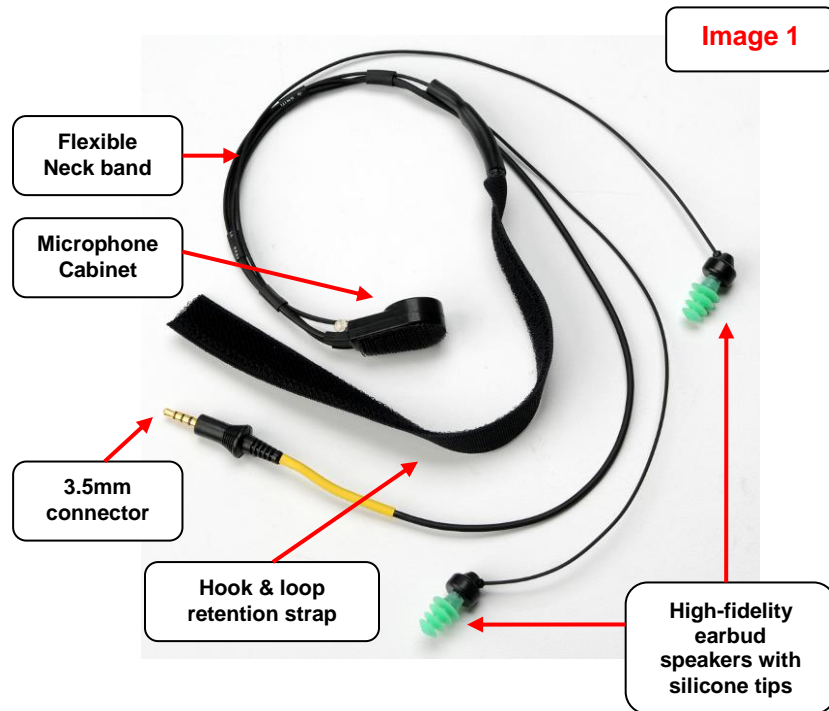

Proper Fitment of Earbud Speakers

The Neckmike silicone earbud tips are designed to provide comfortable hearing protection, while enabling you to hear voice communication, music, navigation instructions, etc. via the built-in speakers. Proper fitment is essential for blocking out unwanted

outside sounds to enable you to hear the relevant audio (intercom, calls, music, etc.).

Neckmike comes with multiple sizes of earbud tips, to fit different diameter and depth of ear canals. The small size is black, medium size is yellow and large size is red/orange (Image 2). Additional sizes and shapes may be included. You should experiment to find the earplug that best fits your ear canal. When fitted correctly, outside noises should sound muted, similar to putting your fingers in your ears.



The silicone earbud tips are attached to the speaker cabinets by gently pushing them into place onto the nozzle (Image 3).



Image 3

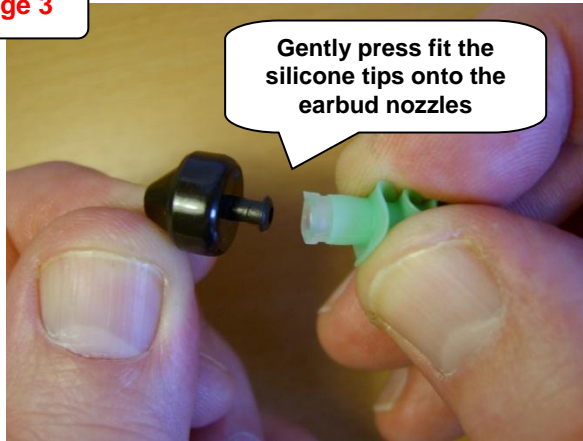

Once the earbud tips are attached to the speakers, insert them into your ears by reaching over head with the opposite hand and gently pulling up and back on outer ear to open the ear canal. With opposite hand, grasp the earplug and gently insert the tip with a circular or wiggling motion to form an airtight seal. For the best seal, rub a few drops of water onto the silicone earplugs prior to insertion (making sure to avoid the center speaker hole of the earbud) or put some water droplets on your finger to wet your ear canal prior to insertion. Lightly wetting the earplugs or ear canal will enable easier insertion into the ear and will provide a better acoustic seal.

The earbud speakers should remain securely in place when there's a good seal, with or without a helmet. If you've inserted the earbud tip as far as is comfortable, but cannot achieve a good seal, try a larger sized tip.

Earplugs may be washed with soap and water as needed.

Foam earbud tips are available for users who prefer foam tips over silicone. Go to www.neckmike.us for more information or to purchase.

NOTICE

Earbud tips should be removed from the micro-speakers prior to cleaning and should be completely dry prior to reattaching to the micro-speakers. Otherwise, the micro-speakers may be damaged by the water.

NOTICE

In some regions or states, the use of headphones or helmet audio is restricted or prohibited. Familiarize yourself with all laws and regulations that apply to your region before using Neckmike and remember that compliance with all laws and regulations is your responsibility.

The AMA maintains a helpful resource of motorcycle laws by state: <http://www.americanmotorcyclist.com/Rights/State-Laws.aspx>

WARNING

Permanent hearing loss may occur if headphones are used at a high volume. Use caution and common sense with the headphone volume level for voice communication and music.

Hearing experts suggest that you limit the amount of time you use headphones at high volume, and avoid turning up the volume to further block out noisy surroundings. Your ear can adapt to a higher volume of sound over time, which may sound normal but can be damaging to your hearing. Set your volume to a safe level before



that happens. If you experience ringing in your ears, reduce the volume or discontinue use of your audio device.

Proper Fitment of the Neckmike Microphone

Neckmike is designed for all-day comfort and the neck band is flexible to accommodate different neck sizes. The microphone cabinet should have full contact against the skin for the best microphone performance. Note that a beard or whiskers in the area of the microphone may be heard as a scratching noise in the background.

The microphone cabinet is held in place by the built-in tension of the neck band. For active use, you should use the included Velcro keeper strap to hold the Neckmike securely in place, at a comfortable tension. Once fitted, the excess strap material (if any) should be trimmed with scissors and discarded (otherwise it will flap in the wind and create noise)

The wire neck band may be gently bent along its radius every inch or two in the direction of the curve to reduce the overall diameter of the neck band, thereby providing a snugger fit against the neck if desired (Image 4).

Image 4



Place the Neckmike around your neck, with the microphone cabinet flush against the skin, approximately 1-2" to either side of your voice box (Image 5). It should be placed relatively high on the neck, otherwise your voice may sound muffled.

Image 5



If your voice is higher pitched, you may want to move the microphone cabinet further away from the voice box for best results.



Experiment with the location of the microphone cabinet while using the intercom to see what position is best for you!

HELPFUL HINT

It is not necessary to shout when using Neckmike in a noisy environment; just speak clearly. The Neckmike microphone is designed to give your voice the best possible quality, even when the surrounding noise is loud.

M4 Bluetooth Unit Overview

The M4 Bluetooth unit is a Class 1 Bluetooth transceiver that is waterproof and includes a glove-friendly handlebar remote. The M4 unit enables one-to-one Bluetooth intercom functionality up to 1,000M between up to four different M4 units (you + 3 others). Note the functional range of the intercom feature will be influenced by terrain such as trees and hills, obstacles such as buildings and weather conditions.

The Neckmike M4 Bluetooth unit may also be paired with Bluetooth-enabled mobile phones for voice calls and music, MP3 players for music and GPS units for guidance and/or music.

The M4 unit is easy to operate with several buttons (Image 6):

- On / Off (motorcycle icon)- Turns the unit on and off
- Phone / Play (phone icon)- Answers and ends phone calls; also controls music start / stop on some phones.
- Volume Up and Down (note that volume “up” is the lower button)
- Rider A, B, C – Opens / Closes Bluetooth intercom session with passenger or other riders

Image 6

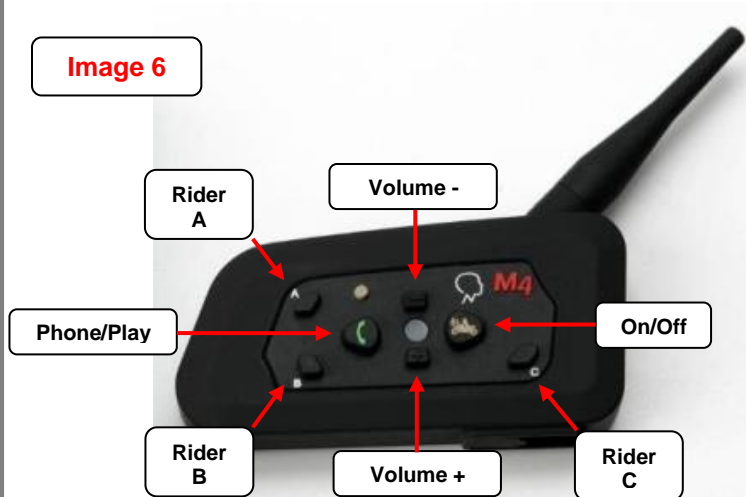

Note that the majority of M4 buttons are duplicated on the handlebar remote for convenient operation.

Other M4 unit operational features (Image 7):

- 3.5mm open port for connecting to Neckmike via the included coiled extension cable
- 2.5mm port (covered with rubber dust cover) to connect the charging cable. May also be used to hardwire a non-Bluetooth MP3 player
- LED indicator light
 - Blue flash every 2-3 seconds when unit is powered on
 - Steady blue flash every 2-3 seconds when unit is on and paired with a mobile phone
 - Quickly flashes blue/red when ready for pairing
 - Solid red while charging
- Reset button – The small gray reset button may be used if



you are having trouble connecting to other M4 units or to a mobile phone. This may result from RF interference which can be caused by high power TV transmitters, airport radars or GSM base stations. Pressing the button will reset the unit and immediately power the unit off if it is turned on.

Resetting the unit does not erase Bluetooth pairings made with mobile phones or other M4 units; however it will reset the volume to a lower preset level.

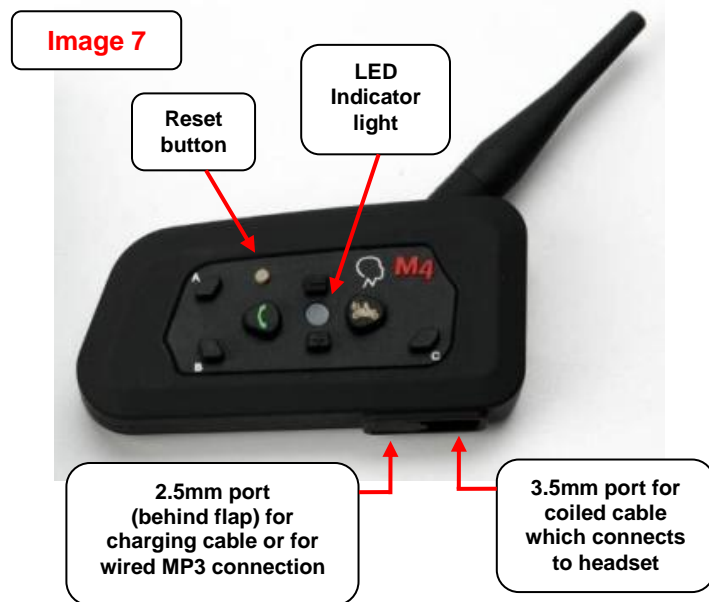

Note that all buttons will “click” when pressed. If you do not feel / hear a “click”, then the button was not activated. Also, note that some functions emit different beeps or tones in the headset to provide audible confirmation. For example, the unit beeps when powered on or off, a two-tone beep is heard at max or minimum volume level, and a beep is heard when opening or terminating an intercom session.

A coiled cable is used to connect between the headset and the M4 Bluetooth unit. It is made with inline filters to reduce the microphone sensitivity, as many riders tend to talk loudly while underway. Also, this cable ensures a positive connection to the Bluetooth unit, with a slightly longer 4 segment plug. The right-angled end goes into the M4 Bluetooth unit and the straight end to the Neckmike headset.

This cable must be used at all times or the headset will not function properly. Always check your cable connections if you notice a change in sound quality or microphone performance.

WARNING

Familiarize yourself with the M4 unit buttons and operation prior to using. It is NOT recommended that you use the M4 unit buttons while riding. Pull over and stop in a safe and legal manner before attempting to operate the unit. The handlebar remote is included for your convenience, but should also be used in a safe and prudent manner after you are familiar with its operation. Always use your best judgment and operate your vehicle in a safe manner.

NOTICE

The M4 Bluetooth unit has an internal lithium-ion polymer battery which should be fully charged before initial use. The normal charge time is approximately three hours. The unit is charged through the 2.5mm charging port at the bottom of the unit, with the USB end of the cable plugged into the included wall charger a computer USB port. While charging, the red LED turns on. When charging is complete, the red LED will turn off. Note that the unit cannot be used while charging.

Do NOT attempt to remove internal lithium-ion polymer battery! It is not user-replaceable.



The M4 Bluetooth battery will enable up to 9 hours of talk time and has a standby life of approximately 120 hours (5 days).

While not in use, it is recommended that you charge the M4 Bluetooth unit on a monthly basis to preserve the capacity of the lithium-ion polymer battery.

M4 Bluetooth Unit Functions and Operation

Basic Operation

To turn the unit on, press and hold the On/Off button (marked with a motorcycle icon) for 5-7 seconds until the blue LED illuminates, then release. If the headset is connected, you will hear an audible tone as the unit powers on. The blue LED will flash every 2-3 seconds to indicate the unit is powered on.

To power off, press and hold the On/Off button for 6-8 seconds until the blue LED is constant, then release. Alternatively, you may press the reset button to immediately power off the unit.

To increase volume, press the volume “+” key. To decrease volume, press the volume “-“ key. Remember the volume “+” key is positioned below the volume “-“ key on the Bluetooth unit. On the remote control, the volume “+” key is positioned above volume “-“.

Bluetooth Pairing

To connect the M4 unit to a Bluetooth device, you must first complete a one-time pairing process. After pairing, the M4 unit and the other Bluetooth device will automatically recognize each other whenever they are turned on and within range (~10 m).

The Neckmike M4 Bluetooth unit may be paired with multiple devices:

- Up to 3 other M4 units (A, B, C) for Bluetooth intercom
- Bluetooth Mobile phones / GPS
- Bluetooth A2DP MP3 player

If you are using a Bluetooth mobile phone and GPS, you should first pair the mobile phone to the GPS device, and then pair the M4 unit to the GPS (see further instructions on page 14).

Pairing with a Mobile Phone

NOTICE

You should only pair one M4 unit at a time to your mobile phone. Other M4 units should be turned off and the handlebar remotes should not be touched during the pairing process.

Pairing Steps

1. Turn on your mobile phone and make sure the Bluetooth function is activated (Bluetooth is normally activated in your phone’s wireless settings menu)
2. Press the reset button on the M4 Bluetooth unit (< 1 second). The unit is now powered off.
3. Press and hold the M4 unit On/Off button approximately 10 seconds until the LED flashes red and blue. (Note that the LED will turn blue as you continue to hold the button, prior to flashing red and blue). The M4 unit will now be discoverable by the mobile phone.
4. From your phone, scan for nearby Bluetooth devices. (Consult your phone Owner’s Manual for more information).



The M4 will appear as “Motor Phone” in the mobile phone menu.

5. When the M4 unit is discovered, select “Motor Phone” in the phone menu to pair. If the mobile phone asks for a PIN or password, enter 0000 (four zeros).
6. Your mobile phone will confirm that the pairing has succeeded. The M4 unit LED will now steadily flash blue every 3-5 seconds to indicate that it is successfully paired.

The M4 unit and mobile unit are now paired and should automatically connect each time they are powered on and within range. After pairing, it may be necessary to tap the Phone/Play button once to establish a connection to the mobile phone.

If the pairing process is not completed within two minutes, the M4 unit will return to standby mode with a quick flashing blue LED every 2-3 seconds.

Using with a Mobile Phone

When you receive a call, the M4 unit will answer automatically after around four rings. To answer the call more quickly, short press the Phone/Play button.

To reject an incoming call prior to the automatic answer, press and hold the Phone/Play button for about 2 seconds when you hear the incoming ring tone and the call will be rejected. To end the call, press the Phone/Play button.

To place a call, you should first pull over and stop in a safe and legal manner, and then dial from your mobile phone as usual.

On some phones, the last number called may be redialed by pressing and holding the Phone/Play button for 2-3 seconds. If your mobile phone is A2DP (Advanced Audio Distribution Profile) compatible, then your phone music will be transmitted in stereo to the Neckmike M4 headset and the Phone/Play button may be used to play and pause the music (depending on your phone model).

Note that phone calls have the highest priority and will automatically interrupt intercom sessions or music. Once a call is complete, the music or intercom session will resume.

HELPFUL HINT

If the connection is ever lost between the M4 unit and mobile phone or you do not hear the phone audio in the headset, tap the Phone/Play button to reestablish the connection.

Remember to always use the coiled extension cable between the M4 unit and the Neckmike headset and check your cable connections if you notice a change in sound quality or microphone performance.

Pairing Two M4 Bluetooth Units

The Neckmike M4 Bluetooth unit may be paired up to three other M4 units for the full duplex Bluetooth intercom feature. Note that even with three other M4 units paired, intercom sessions are always made between two units at a time.

Note: If you purchased a Neckmike M4 Twin Pack, the two units are already paired from the factory and with the units powered on, the intercom may be activated by pressing press any button (A, B, C) to open or close the intercom with the other unit. Either unit can open or close the intercom session.



For units which are not already paired, the initial pairing is a one-time process. Once the units have been paired, they will automatically recognize each other whenever they are powered on and are within range.

First label each M4 unit A, B, C or D (as applicable). To pair the first two units (A, B), make sure the other M4 units are powered off and no buttons are pressed on the handlebar remotes during the pairing process.

1. Press the reset button on each unit (< 1 second).
2. Turn on unit A and unit B by pressing and holding the On/Off button (marked with a motorcycle icon) for 5-7 seconds until the blue LED illuminates, then release. The blue LED will flash every 2-3 seconds to indicate that each unit is powered on.
3. Press and hold the button labeled "B" on unit A, and the button labeled "A" on unit B until the LED flashes red and blue, then release. The units are now in pairing mode.
4. Next, short press button "B" on unit A. After several seconds, both units will resume flashing the blue LED every 2-3 seconds once the pairing is complete.

You have now completed the one-time pairing process between units A and B, and the intercom function is ready for use.

Note that the intercom session is normally active following the pairing process. You should press the "B" button on unit A or the "B" button on unit A to disconnect the active intercom session if you are not using it.

These units will now automatically pair whenever they are within range of each other.

If for some reason this process is not successful the first time, repeat step 4, or press the reset button on each unit and perform steps 2-4 again.

Using the M4 Bluetooth Unit Intercom

Opening and closing intercom sessions is as easy as pushing a button. If you are using unit A, and your fellow rider is using unit B, short press the "B" button on unit A to open the intercom. You will hear a short beep when you press the button to begin. It normally takes 3-5 seconds for the intercom session to open. If you are listening to music, the music will be paused (Image 8,9).

Image 8
Rider-to-Rider

*Unit A presses
"B" to connect
with unit B*

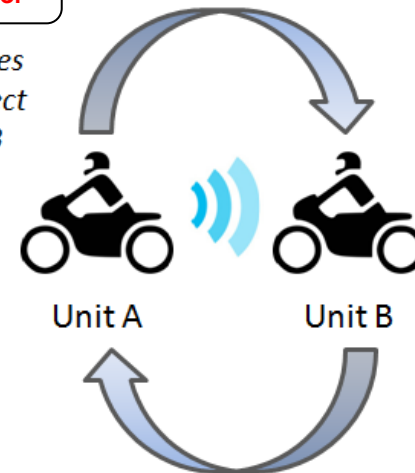

*Unit B presses
"A" to connect
with unit A*



Image 9
Rider-to-Passenger

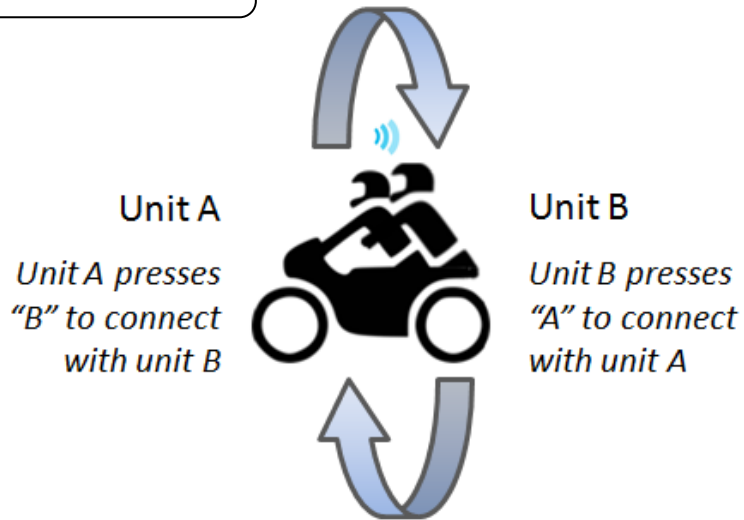

The intercom supports full duplex communication, similar to a phone call. This means both users can speak and listen at the same time.

To end the intercom session, you simply press the same button that was used to open the session. You will hear a longer beep which confirms the button press.

Either person can initiate or end the intercom session by pressing the appropriate button.

Note that if the unit you are trying to intercom with is already in an active intercom session or phone call or is out of range, you will hear a long low beep tone to indicate the connection cannot be made.

Also note that phone calls have the highest priority and will automatically interrupt the intercom session. Once a call is complete, the intercom session will resume.

HELPFUL HINT

The M4 unit battery life can be maximized by closing active intercom sessions when not in use.

Pairing Additional M4 Bluetooth Units

If you are using more than two M4 units, they will be paired in the same way as the first two units. For example, if you are pairing a third device (unit C), you will first pair units A and B, and then pair unit A to unit C, followed by unit B to unit C.

To pair unit A to unit C, make sure the other M4 units are powered off and no buttons are pressed on the handlebar remotes during the pairing process.

1. Press the reset button on each unit (< 1 second).
2. Turn on unit A and unit C by pressing and holding the On/Off button (marked with a motorcycle icon) for 5-7 seconds until the blue LED illuminates, then release. The blue LED will flash every 2-3 seconds to indicate that each unit is powered on.



3. Press and hold the button labeled “C” on the unit A, and the button labeled “A” on unit C until the LED flashes red and blue, then release. The units are now in pairing mode.
4. Next, short press button “C” on unit A. After several seconds, both units will resume flashing the blue LED every 2-3 seconds once the pairing is complete

You have now completed the one-time pairing process between these two units, and the intercom function is ready for use. Note that the intercom session is normally active following the pairing process. You should press button “C” on unit A or button “A” on unit C to disconnect the active intercom session if you are not using it.

If for some reason this process is not successful the first time, repeat step 4, or press the reset button on each unit and perform steps 2-4 again.

To pair unit B to unit C, follow the same process. First, make sure the other M4 units are powered off and no buttons are pressed on the handlebar remotes during the pairing process.

1. Press the reset button on each unit (< 1 second).
2. Turn on unit B and unit C by pressing and holding the On/Off button (marked with a motorcycle icon) for 5-7 seconds until the blue LED illuminates, then release. The blue LED will flash every 2-3 seconds to indicate that each unit is powered on.
3. Press and hold the button labeled “C” on the unit B, and the button labeled “B” on unit C until the LED flashes red and blue, then release. The units are now in pairing mode.

4. Next, short press button “C” on unit B. After several seconds, both units will resume flashing the blue LED every 2-3 seconds once the pairing is complete

Note that the intercom session is normally active following the pairing process. You should press button “C” on unit B or button “B” on unit C to disconnect the active intercom session if you are not using it.

If for some reason this process is not successful the first time, repeat step 4, or press the reset button on each unit and perform steps 2-4 again.

Because there is no unit “D” button on the M4 units, you will use the button with each unit’s assigned letter (A, B or C) to reach unit D. For example, unit A would pair and communicate with unit D using its “A” button, unit B would pair and communicate with unit D with its “B” button and unit C would pair and communicate with unit D with its “C” button (Image 10).



Image 10

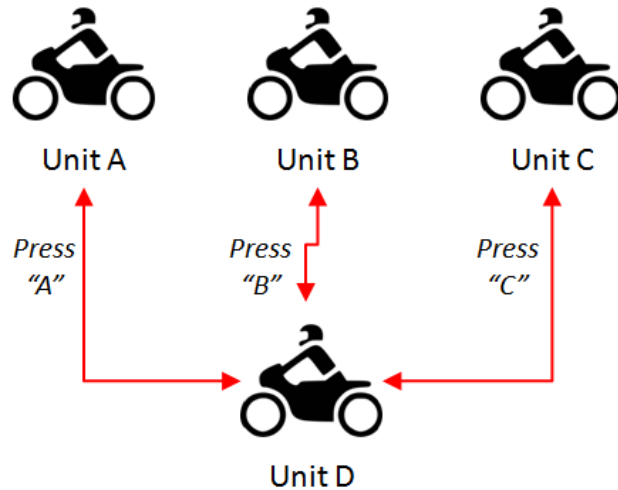

Pair each unit with unit D as indicated in the steps above for pairing additional M4 units.

BONUS FEATURE

An unadvertised feature of the M4 is the ability to pair a fourth unit to the On / Off button (with a motorcycle icon). This is not advertised, as there are only three intercom buttons on the handlebar remote, and this connection may only be established with a short press of the On/Off button on the M4 unit itself.

For example, you could pair a unit E with unit A. **To pair unit A to unit E**, make sure all other units are powered off during the pairing process.

1. Press the reset button on each unit (< 1 second).

2. On unit E, press and hold the On / Off button (marked with a motorcycle icon) for 5-7 seconds until the blue LED illuminates, then release. The blue LED will flash every 2-3 seconds to indicate that unit E is powered on.
3. On unit E, press and hold button "A" until the LED flashes red and blue, then release. This unit is now in pairing mode.
4. On unit A, press and hold the On/Off button (marked with a motorcycle icon) on unit A for approximately 10 seconds until the LED flashes red and blue. (Note that the LED will turn blue as you continue to hold the button, prior to flashing red and blue). Unit A is now in pairing mode, similar to when you paired it with your mobile phone.
5. Next, short press the On / Off button on unit A. After 5-9 seconds, both units will resume flashing the blue LED every 2-3 seconds to indicate the pairing is complete.

Note that the intercom session is normally active following the pairing process. You should press button "A" on unit E or short press the On / Off button on unit A to disconnect the active intercom session if you are not using it.

If for some reason this process is not successful the first time, repeat step 5 or press the reset button on each unit and perform steps 2-5 again.

Pairing with a GPS Navigation Device

If you are using a Bluetooth-enabled GPS device which supports audio functions, first pair your mobile phone to the GPS, and then pair the GPS to the M4 unit as a headset. This will allow you to hear navigation voice prompts with the Neckmike headset, while using the GPS screen to accept or reject phone calls.



The M4 unit should be powered off to begin.

1. Turn on your GPS and make sure the Bluetooth function is activated in the GPS menu settings.
2. From the GPS device menu, scan for nearby Bluetooth devices to pair with your mobile phone. (Consult your GPS Owner's Manual for more information).
3. After following the GPS device instructions to successfully pair with your mobile phone, follow the GPS device menu instructions to pair with the M4 unit as a headset.
4. Press and hold the M4 unit On/Off button approximately 10 seconds until the LED flashes red and blue. The M4 unit will now be discoverable by the GPS, and will appear as "Motor Phone" in the mobile GPS menu.
5. When the M4 unit is discovered, select "Motor Phone" in the GPS device menu to pair. If the GPS asks for a PIN or password, enter 0000 (four zeros).

Your GPS should confirm that the pairing has succeeded.

The M4 and the GPS device should automatically connect each time they are powered on and within range (~10 m).

If the pairing process is not completed within two minutes, the M4 unit will return to standby mode with a quick flashing blue LED every 2-3 seconds.

Note that GPS units with built-in music functions (ex. Garmin zumo 660, 665, 550) become the audio source when paired to the M4, and you cannot use a different A2DP music source over Bluetooth while paired to the GPS (i.e. music from your mobile phone or Bluetooth-enabled MP3 player). However, you may hardwire a different audio source with the included 2.5 mm to 3.5 mm audio cable if desired.

The hardwired audio has the lowest priority and will be superseded by active phone calls, intercom sessions or GPS prompts.

Pairing with an MP3 Player

The Neckmike M4 headset may be paired with an MP3 player which supports the A2DP stereo Bluetooth profile. Please consult your MP3 player Owner's Manual to see if your device supports A2DP.

The instructions for pairing the M4 to an MP3 player are similar to a mobile phone or GPS:

1. Turn on your MP3 player and make sure the Bluetooth function is activated in the MP3 player menu settings
2. From your MP3 player, scan for nearby Bluetooth devices. (Consult your MP3 device Owner's Manual for more information).
3. Press and hold the M4 unit On/Off button approximately 10 seconds until the LED flashes red and blue. The M4 unit will now be discoverable by the MP3 player, and will appear as "Motor Phone" in the music player menu.
4. Select "Motor Phone" in the device menu to pair. If it asks for a PIN or password, enter 0000 (four zeros).

Your MP3 player should confirm that the pairing has succeeded.

The M4 and the MP3 device should automatically connect each time they are powered on and within range (~10 m).

If the pairing process is not completed within two minutes, the M4 unit will return to standby mode with a quick flashing blue LED every 2-3 seconds.



Note: The Neckmike M4 unit can also receive audio from non-Bluetooth enabled MP3 players and other audio sources via the included 2.5 mm to 3.5 mm audio cable. The hardwired audio has the lowest priority and will be superseded by active phone calls, intercom sessions or GPS prompts.

Mounting the M4 Bluetooth Unit

The M4 Bluetooth unit is designed to be mounted onto the left side of a helmet. The clamp mount is attached between the helmet's outer shell and inner padding. The rectangular plate is inserted on the inside of the helmet shell and affixed with screws to the oval-shaped clip which rests on the outside of the helmet shell (Image 11).

Image 11



Once the helmet clip is in place, the M4 unit attaches to the bracket by inserting lining up the mounting tabs on the back of the M4 unit into the grooves in the bracket until it "clicks" firmly into place. (Image 12).

Image 12



To release the unit from the bracket, press on the tab at the bottom of the mounting bracket and gently slide the M4 unit upwards.

The Neckmike is attached to the M4 Bluetooth unit via the coiled extension cable that is included in the package. Be certain that the cable is fully inserted into the 3.5mm port on the M4 Bluetooth unit, otherwise the Neckmike will not function properly and the audio may sound distorted.

To use the M4 Bluetooth unit without a helmet, an accessory arm band is available to attach the M4 unit to the user's arm. Go to www.neckmike.us for more information or to purchase.

The M4 Bluetooth unit may also be placed in a jacket or vest pocket for use without a helmet, and the handlebar remote can be used to control all functions. Note that this may reduce the range of the Bluetooth intercom by 50% or more.

M4 Wireless Handlebar Remote

The Neckmike M4 Bluetooth includes a unique and easy-to-install wireless handlebar remote (Image 13).





Image 13

This remote enables you to easily answer / end phone calls, open / close Bluetooth intercom sessions, start / stop music and to control volume. The handlebar remote gives you full control over your communication with your passenger or friends while riding.

Note there is a 1-5 second delay after a selected button is pushed before activation, depending on the function. Once a button is pushed, there is no need to press it again as the requested function will automatically activate. Pressing the selected button more than once may confuse the main M4 unit.

The M4 remote is always ready to use, and does not have a separate on/off switch. It has a built-in rechargeable lithium battery, which should be charged fully before the first use, using the included charging cable. (Note that the M4 unit and handlebar remote use the same USB charging cable). The handlebar remote is an RF remote, so the battery is only used when pressing a button. Therefore, the remote offers a very long battery life (measured in weeks or even months, depending on how often you use it). A red LED will

illuminate behind the volume buttons on the remote when you press a button and the battery is charged.

The handlebar remote should be placed in a safe and convenient location where it does not interfere with any other controls (Image 14). To install, simply clip the rear mounting bracket into the top backside of the remote, position the bracket around and behind the handlebar and secure in place with the screw and captive nut at the bottom of the remote. Two different sized mounting brackets are included for different sized grips or handlebars, along with two flat rubber spacers to facilitate a better fit around the handlebar or grip as necessary.

WARNING

The handlebar remote should not be used if it unduly interferes with the motorcycle controls or your ability to fully grip the handlebars and maintain full control over your motorcycle.

Image 14



Support

For additional information please visit our website at www.neckmike.us

You can also reach us at: support@neckmike.us

Notifications

Battery Warning

If these guidelines are not followed, the internal lithium-ion polymer battery may experience a shortened life span or may present a risk of damage to the M4 Bluetooth device, fire, chemical burn, electrolyte leak, and/or injury.

- Do not attempt to remove the non-user-replaceable battery.
- Do not leave the M4 unit exposed to a heat source or in a high temperature location.
- Do not puncture or burn the device or battery.
- Do not operate the device outside of the following temperature range: -20°C to 55°C (-4°F to 131°F)
- When storing the device for an extended time, keep within the following temperature range: 0°C to 25°C (32°F to 77°F)
- Contact your local waste disposal department for proper device / battery disposal in accordance with relevant local laws and regulations

Declaration of Conformity- Bluetooth®

The Product is compliant with and adopts the Bluetooth specification 2.1 and has successfully passed all interoperability tests that are specified in the Bluetooth® specification. However, interoperability between the device and other Bluetooth®-enabled products is not guaranteed.

FCC Compliance

This equipment has been tested and found to comply with the limits for a Class B digital device, pursuant to part 15 of the FCC rules. Operation is subject to the following conditions: (1) this device may not cause harmful interference, and (2) this device must accept any interference received, including interference that may cause undesired operation.

These limits are designed to provide reasonable protection against harmful interference in a residential installation. This equipment generates, uses, and can radiate radio frequency energy and may cause harmful interference to radio communications if not installed and used in accordance with the instructions. However, there is no guarantee that interference will not occur in a particular installation. If this equipment does cause harmful interference to radio or television reception, which can be determined by turning the equipment off and on, the user is encouraged to try to correct the interference by one of the following measures:

- Reorient or relocate the receiving antenna
- Increase the separation between the equipment and the receiver.
- Connect the equipment into an outlet that is on a different circuit from the M4 unit
- Consult the dealer or an experienced radio/TV technician for help.

This product does not contain any user-serviceable parts. Repairs should only be made by Neckmike USA. Unauthorized repairs or modifications could result in permanent damage to the equipment, and void your warranty and your authority to operate this device under Part 15 regulations.



Copyright

All rights reserved. The content of this User Guide may not be copied, in whole or in part, without the written consent of Neckmike USA and is protected by copyright laws.

IMPORTANT SAFETY INFORMATION

Neckmike USA (the “Company”) notifies you that your complete and undivided attention is required when using the Neckmike M4 Bluetooth series communication system (the “Product”). Failure to avoid potentially hazardous situations could result in serious injury or even death. The Company encourages you to take all necessary precautions and remain alert to your surroundings including traffic, weather, road conditions and terrain. It is best to pull over and stop in a safe and legal manner away from traffic prior to activating or deactivating the Product or initiating or receiving any calls. Do not perform any Bluetooth pairing while riding.

The User Guide is intended to cover technical capabilities of the Product and should not be interpreted as encouraging the operation of the Product in any manner that is unsafe or prohibited by law. Always exercise due caution when using this Product and obey all relevant traffic laws.

Do not become distracted by the Product while operating any vehicle. Do not operate the Product if it is unsafe to do so.

In some regions or states, the use of headphones or helmet audio is restricted or prohibited. Familiarize yourself with all laws and regulations that apply to your region before using the Product and remember that compliance with all laws and regulations is the user’s responsibility. Use the Product while operating your vehicle only where and how permitted by the applicable law.

The AMA maintains a helpful resource of motorcycle laws by state: <http://www.americanmotorcyclist.com/Rights/State-Laws.aspx>

Use care when installing the Product so that the Product is secure.

Limited Warranty

This Neckmike product is warranted to be free from defects in materials or workmanship for one year from the date of purchase. Within this period, Neckmike USA will, at its sole discretion, repair or replace any components that fail in normal use. Such repairs or replacement will be made at no charge to the customer for parts or labor, provided that the customer shall be responsible for any shipping cost. This warranty does not apply to: (i) cosmetic damage, (ii) consumable parts such as batteries, unless product damage has occurred due to a defect in materials or workmanship; (iii) damage caused by accident, abuse, misuse, water, flood, fire, or other acts of nature or external causes; (iv) damage caused by service performed by anyone who is not an authorized service provider of Neckmike USA; or (v) damage to a product that has been modified or altered without the written permission of Neckmike USA.

In addition, Neckmike USA reserves the right to refuse warranty claims against products or services that are obtained and/or used in violation of the laws of any country.

THE WARRANTIES AND REMEDIES CONTAINED HEREIN ARE EXCLUSIVE AND IN LIEU OF ALL OTHER WARRANTIES EXPRESS, IMPLIED, OR STATUTORY, INCLUDING ANY LIABILITY ARISING UNDER ANY WARRANTY OF MERCHANTABILITY OR FITNESS FOR A PARTICULAR PURPOSE, STATUTORY OR OTHERWISE. THIS WARRANTY GIVES YOU SPECIFIC LEGAL RIGHTS, WHICH MAY VARY FROM STATE TO STATE OR REGION. IN NO EVENT SHALL NECKMIKE USA BE LIABLE FOR ANY INCIDENTAL, SPECIAL, INDIRECT OR CONSEQUENTIAL DAMAGES, INCLUDING, WITHOUT LIMITATION, DAMAGES TO PROPERTY, TRAFFIC FINES OR



CITATIONS, WHETHER RESULTING FROM THE USE, MISUSE OR INABILITY TO USE THE PRODUCT OR FROM DEFECTS IN THE PRODUCT. SOME STATES DO NOT ALLOW THE EXCLUSION OF INCIDENTAL OR CONSEQUENTIAL DAMAGES, SO THE ABOVE LIMITATIONS MAY NOT APPLY TO YOU.

Neckmike USA retains the exclusive right to repair or replace (with a new or remanufactured replacement product) the device or offer a full refund of the purchase price at its sole discretion. SUCH REMEDY SHALL BE YOUR SOLE AND EXCLUSIVE REMEDY FOR ANY BREACH OF WARRANTY.

To obtain warranty service, contact Neckmike USA for shipping instructions and a return authorization number. You must securely package the unit and include a copy of the original sales receipt, which is required as the proof of purchase for warranty repairs.



Neckmike USA
18460 S. Ridgeview Road
Olathe, KS 66062
USA

www.neckmike.us

