



M3 Bluetooth®  
User Guide



© 2013 Neckmike USA

## Table of Contents

Quick Start Guide	2
Neckmike Components	3
Proper Fitment and Care of Earplug Speakers	3
Proper Fitment of Neckmike Microphone	5
M3 Bluetooth Unit Overview	6
M3 Bluetooth Unit Functions and Operation	
Basic Operation	8
Bluetooth Pairing	8
Pairing with a Mobile Phone	9
Using with a Mobile Phone	9
Pairing Two M3 Bluetooth Units	10
Using the M3 Unit Intercom	11
Pairing a Third M3 Bluetooth Unit	12
Pairing with a GPS Navigation Device	13
Pairing with an MP3 Player	13
Mounting the M3 Bluetooth Unit	14
Support	15
Notifications	
Battery Warning	15
Declaration of Conformity- Bluetooth®	15
FCC Compliance	15
Copyright	16
IMPORTANT SAFETY INFORMATION	16
Limited Warranty	17

Thank you for choosing the Neckmike M3 Bluetooth communication system!

Neckmike enables communication while providing hearing protection in high noise environments with a unique and patented headset design. Please follow the instructions in this User Guide to get the best results from your Neckmike.

*--Proper fitment is essential to achieve good results--*

Save this manual for future reference.

## Quick Start Guide

### Fitting the Neckmike headset

- Place the Neckmike around your neck, with the microphone cabinet 1-2" (3-5cm) to the side of your voice box. It should be placed relatively high on the neck, otherwise your voice may sound muffled.
- Install the earplugs by reaching over head and gently pull up and back on outer ear to the straighten ear canal. With opposite hand, grasp the earplug stem and insert with a circular motion to form an airtight seal. Lightly wetting the earplugs or ear canal will enable easier insertion into the ear and will provide a better acoustic seal. When fitted correctly, it should be as quiet as when you put your fingers in your ears. Multiple earplug sizes are included so you can find the one that offers the best fit and the most hearing protection.
- Connect the Neckmike via the coiled extension cable to the M3 Bluetooth unit.

### Operating the M3 Bluetooth unit

- You must first charge the M3 unit battery prior to operation. (Please see detailed instructions).
- Press and hold the Power/Intercom button (marked with a motorcycle icon) for 5-6 seconds until the blue LED illuminates, then release. The LED will flash approximately every two seconds to indicate the unit is powered on.
- Pair with your mobile phone for voice calls and music, GPS for guidance, or additional M3 units for rider-to-passenger or bike-to-bike communication via Bluetooth. (Please see detailed instructions).
- To power off, press and hold the Power/Intercom button for 6-8 seconds until the blue LED is constant, then release. Alternatively,

you may press the small reset button to immediately power off the unit.

## Neckmike Components

The Neckmike is comprised of several components, which are referenced in this User Guide (Image 1).

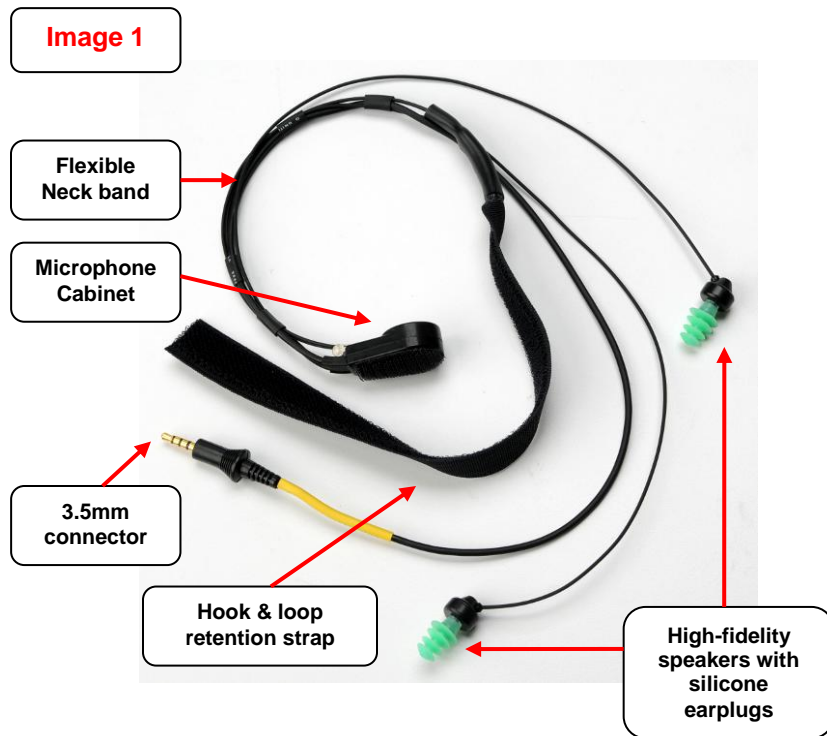

## Proper Fitment and Care of Earplug Speakers

The Neckmike silicone earplugs are designed to provide comfortable hearing protection, while enabling you to hear voice communication, music, navigation instructions, etc. via the built-in speakers. Proper fitment is essential for blocking out unwanted outside sounds and enabling you to hear the relevant audio (intercom, music, etc.) enabled by Neckmike.

Neckmike comes with multiple sizes of earplugs, to fit different diameter and depth of ear canals. The small size is black, medium size is green and large size is blue (Image 2). Additional earplugs with different sizes and shapes may be included. You should experiment to find the earplug that best fits your ear canal. When fitted correctly, outside noises should sound muted, similar to putting your fingers in your ears.



The silicone earplugs are attached to the stereo micro-speakers by gently pushing them into place (Image 3).

**Image 3**

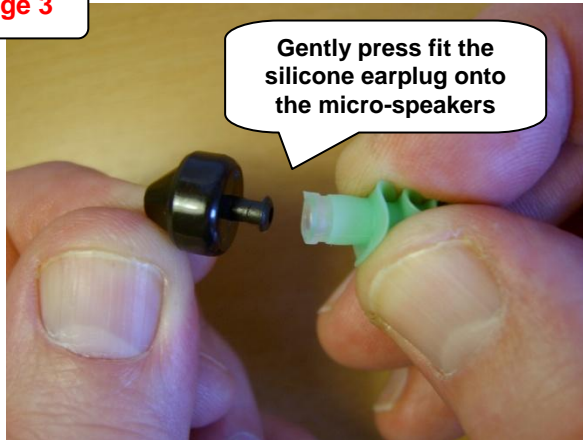

Install the earplugs by reaching over head with the opposite hand and gently pulling up and back on outer ear to straighten the ear canal. With opposite hand, grasp the earplug and insert with a circular or wiggling motion to form an airtight seal. For the best seal, rub a few drops of water onto the earplugs prior to insertion (make sure to avoid the center speaker hole of the earplug) or put some water droplets on your finger to wet your ear canal prior to insertion. Lightly wetting the earplugs or ear canal will enable easier insertion into the ear and will provide a much better acoustic seal.

The earplug should remain securely in place when there's a good seal. If you've inserted the earplug as far as is comfortable, but cannot achieve a good seal, try a larger size earplug.

If your ear canals are shallow and / or you are having trouble achieving a good seal, then the green or blue earplugs may be modified by removing the smallest flange at the end in order to improve the fit. This can be done with sharp scissors or razor blade (Image 4).

**Image 4**



If you wear a helmet with Neckmike, you should also shorten the earplugs on the end which affixes to the micro-speakers, so that the earplugs are not easily knocked out of position while putting on your helmet and do not protrude uncomfortably inside the helmet (Image 5).

**Image 5**

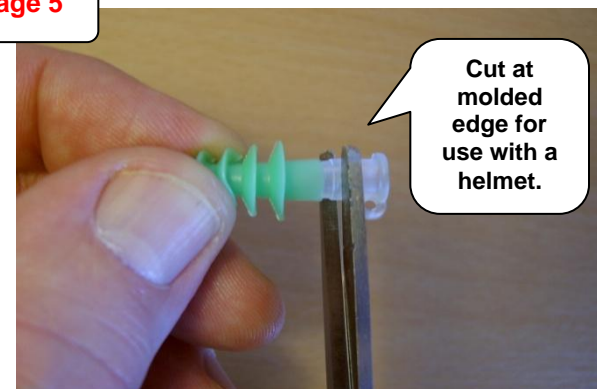

Earplugs may be washed with soap and water as needed.

### NOTICE

Earplugs should be removed from the micro-speakers prior to cleaning and should be completely dry prior to reattaching to the micro-speakers. Otherwise, the micro-speakers may be damaged by the water.

### NOTICE

In some regions or states, the use of headphones or helmet audio is restricted or prohibited. Familiarize yourself with all laws and regulations that apply to your region before using Neckmike and remember that compliance with all laws and regulations is your responsibility.

The AMA maintains a helpful resource of motorcycle laws by state: <http://www.americanmotorcyclist.com/Rights/State-Laws.aspx>

### WARNING

**Permanent hearing loss may occur if headphones are used at a high volume.** Use caution and common sense with the headphone volume level for voice communication and music.

Hearing experts suggest that you limit the amount of time you use headphones at high volume, and avoid turning up the volume to further block out noisy surroundings. Your ear can adapt to a higher volume of sound over time, which may sound normal but can be damaging to your hearing. Set your volume to a safe level before that happens. If you experience ringing in your ears, reduce the volume or discontinue use of your audio device.

## Proper Fitment of the Neckmike Microphone

Neckmike is designed for all-day comfort and the neck band is flexible to accommodate different neck sizes. The microphone cabinet should have full contact against the skin for the best microphone performance. Note that a beard or whiskers in the area of the microphone may be heard as a scratching noise in the background.

The microphone cabinet is held in place by the built-in tension of the neck band. For active use, you should use the included hook and loop retention strap to hold the Neckmike securely in place. Once comfortably fitted, the extra strap material (if any) should be trimmed with scissors.

Using both hands, gently bend the neck band into a 2-3" (6-7cm) diameter prior to wearing. This will help to ensure proper tension in the band (Image 6). This should be done each time you wear the Neckmike.

Image 6

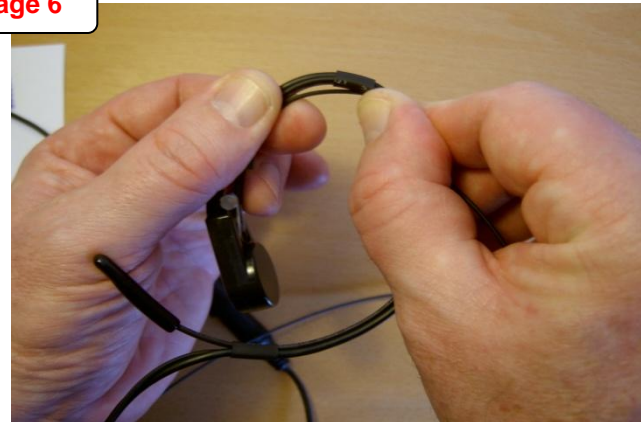



Place the Neckmike around your neck, with the microphone cabinet flush against the skin, approximately 1-2" (3-5cm) to the side of your voice box. It should be placed relatively high on the neck, otherwise your voice may sound muffled (Image 7).

Image 7



If your voice is higher pitched, you may want to move the microphone cabinet further away from the voice box for best results. Experiment with the location of the microphone cabinet while using the intercom to see what position is best for you.

#### HELPFUL HINT

It is not necessary to shout when using Neckmike in a noisy environment; just speak clearly. The Neckmike microphone is designed to give your voice the best possible quality, even when the surrounding noise is strong.

## M3 Bluetooth Unit Overview

The M3 Bluetooth unit is a Class 1 Bluetooth transceiver that is waterproof for weather resistance. The M3 unit enables one-to-one Bluetooth intercom functionality up to 1,000M between up to three different M3 units (You + 2 others). Note the functional range of the intercom feature will be influenced by terrain such as trees and hills, obstacles such as buildings and weather conditions.

The Neckmike M3 Bluetooth unit may also be paired with Bluetooth-enabled mobile phones for voice calls and music, MP3 players for music and GPS units for guidance and/or music (Image 8).

Image 8



The M3 unit is easy to operate with several buttons (Image 9):

- Power / Intercom (motorcycle icon)- Turns the unit on and off and opens / closes Bluetooth intercom sessions with passenger or other riders
- Phone / Play (phone icon)- Connects and disconnects phone calls; also controls music start / stop on some mobile phones.
- Volume Up and Down (note that volume “up” is the lower button)

Other M3 unit operational features (Image 9):

- 3.5mm open port for connecting to Neckmike via the included coiled extension cable
- 2.5mm port (covered with rubber dust cover) for charging cable, and to hardwire MP3 music player
- LED indicator light
  - Blue flash every 2-3 seconds when unit is powered on
  - Steady blue flash every 2-3 seconds when unit is on and paired with a mobile phone
  - Quickly flashes blue/red when ready for pairing
  - Solid red while charging
- Reset button – Resets the unit in case of RF interference caused by high power TV transmitters, airport radars or GSM base stations. Press < 1 second to reset the unit. If the unit is on, it will immediately power off when reset, which makes this button a quick and convenient way to power off the unit. Hitting the reset button will not delete any Bluetooth pairings with mobile phones, other M3 units, etc.

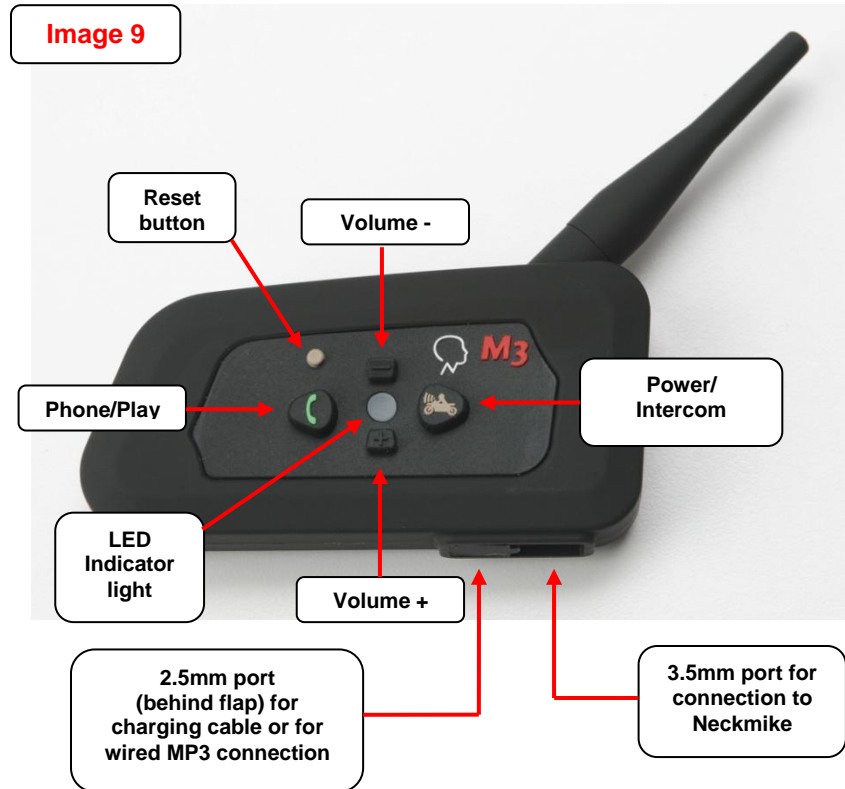

Note that all buttons will “click” when pressed. If you do not feel / hear a “click”, then the button was not activated. Also, note that some functions emit different beeps or tones in the headset to provide additional feedback. For example, the unit beeps when powered on or off, a two-tone beep is heard at max or minimum volume level, and a beep is heard when opening or terminating an intercom session.

Always use the coiled extension cable between the M3 unit and the Neckmike headset and check your cable connections if you notice a

change in sound quality or microphone performance.

### **WARNING**

Familiarize yourself with the M3 unit buttons and operation prior to using. It is NOT recommended that you operate the M3 unit buttons while riding. Pull over and stop in a safe and legal manner before attempting to operate the unit. Always use your best judgment and operate your vehicle in a safe manner.

### **NOTICE**

The M3 Bluetooth unit has an internal lithium-ion polymer battery which should be fully charged before initial use. The normal charge time is approximately three hours. The unit is charged through the 2.5mm charging port at the bottom of the unit, with the USB end of the cable plugged into the included wall charger or a computer USB port. While charging, the red LED turns on. When charging is complete, the red LED will turn off. Note that the unit cannot be used while charging.

Do NOT attempt to remove internal lithium-ion polymer battery! It is not user-replaceable.

The M3 Bluetooth battery will enable up to 9 hours of talk time and has a standby life of approximately 120 hours (5 days).

While not in use, it is recommended that you charge the M3 Bluetooth unit on a monthly basis to preserve the capacity of the lithium-ion polymer battery.

## **M3 Bluetooth Unit Functions and Operation**

### **Basic Operation**

To turn the unit on, press and hold the Power/Intercom button (marked with a motorcycle icon) for 5-7 seconds until the blue LED illuminates, then release. The blue LED will flash every 2-3 seconds to indicate the unit is powered on.

To power off, press and hold the Power/Intercom button for 6-8 seconds until the blue LED is constant, then release. Alternatively, you may press the reset button to immediately power off the unit.

To increase volume, press the volume “+” key. To decrease volume, press the volume “-“ key. Remember the volume “-” key is positioned above the volume “+“ key.

Note that adjustments can only be made when there is an active audio source (ex. Bluetooth intercom session, phone call, music source, etc.).

### **Bluetooth Pairing**

To connect the M3 unit to a Bluetooth device, you must first complete a one-time pairing process. After pairing, the M3 unit and the other Bluetooth device will automatically recognize each other whenever they are turned on and within range (~10 m).

The Neckmike M3 Bluetooth unit may be paired with multiple devices:

- Up to 2 other M3 units for Bluetooth intercom
- Bluetooth Mobile phones / GPS
- Bluetooth A2DP MP3 player



If you are using a Bluetooth mobile phone and GPS, you should first pair the mobile phone to the GPS device, and then pair the M3 unit to the GPS (see further instructions on page 13).

### Pairing with a Mobile Phone

#### NOTICE

You should only pair one M3 unit at a time to your mobile phone. Other M3 units should be turned off during the pairing process.

### Pairing Steps

1. Turn on your mobile phone and make sure the Bluetooth function is activated (Bluetooth is normally activated in your phone's wireless settings menu)
2. Press the reset button on the M3 Bluetooth unit (< 1 second). The unit is now powered off.
3. Press and hold the M3 unit Power/Intercom button approximately 10 seconds until the LED flashes red and blue. (Note that the LED will turn blue as you continue to hold the button, prior to flashing red and blue). The M3 unit will now be discoverable by the mobile phone
4. From your phone, scan for nearby Bluetooth devices. (Consult your phone Owner's Manual for more information). The M3 will appear as "Motor Phone" in the mobile phone menu.
5. When the M3 unit is discovered, select "Motor Phone" in the phone menu to pair. If the mobile phone asks for a PIN or password, enter 0000 (four zeros).
6. Your mobile phone will confirm that the pairing has succeeded. The M3 unit LED will now steadily flash blue every 3-5 seconds to indicate that it is successfully paired.

The M3 unit and mobile unit are now paired and should automatically connect each time they are powered on and within range. After pairing, it may be necessary to tap the Phone/Play button once to establish a connection to the mobile phone.

If the pairing process is not completed within two minutes, the M3 unit will return to standby mode with a quick flashing blue LED every 2-3 seconds.

### Using with a Mobile Phone

When you receive a call, the M3 unit will answer automatically after 3-5 seconds. To end the call, press the Phone/Play button.

To reject an incoming call prior to the automatic answer, press the Phone/Play button immediately when you hear the incoming ring tone and hold for about 2 seconds.

To place a call, you should first pull over and stop in a safe and legal manner, and then dial from your mobile phone as usual. The Neckmike M3 Bluetooth system will then pick up the call in the headset.

On some phones, the last number called may be redialed by pressing and holding the Phone/Play button for 2-3 seconds.

If your mobile phone is A2DP (Advanced Audio Distribution Profile) compatible, then your phone music will be transmitted in stereo to the Neckmike M3 headset and the Phone/Play button can be used to play and pause the music (depending on your phone model).

Note that phone calls have the highest priority and will automatically interrupt intercom sessions or music. Once a call is complete, the music or intercom session will resume. GPS voice prompts over Bluetooth are the second highest priority and will also interrupt intercom sessions and music.

### HELPFUL HINT

If the connection is ever lost between the M3 unit and mobile phone or you do not hear the phone audio in the headset, tap the Phone/Play button to reestablish the connection.

Remember to always use the coiled extension cable between the M3 unit and the Neckmike headset and check your cable connections if you notice a change in sound quality or microphone performance.

### Pairing Two M3 Bluetooth Units

A single Neckmike M3 Bluetooth unit may be paired up to two other M3 units for full duplex communication over Bluetooth. Note that even when three M3 units are paired, intercom sessions are always made between two units at a time.

Note: If you purchased a Neckmike M3 Twin Pack, the two units are already paired from the factory, and with the units powered on, the intercom may be activated with a short press of the Power/Intercom button. Either unit can open or close the intercom session.

The initial pairing is a one-time process. Once the units have been paired, they will automatically recognize each other whenever they are powered on and are within range.

To begin the one-time pairing process between two units, first make sure other nearby Neckmike Bluetooth units are powered off.

1. Press the reset button on each unit (< 1 second).
2. Press and hold the Power/Intercom button (marked with a motorcycle icon) on both units for approximately 10 seconds until the LED flashes red and blue, then release. (Note that the LED will turn blue while you continue to hold the button, prior to flashing red and blue). The units are now in pairing mode.
  - a. If you do not get the unit into pairing mode on the first try (and the LED is flashing blue every two seconds to indicate the power is on), press the reset button to turn the power off and repeat this step.
3. With the LED flashing red and blue, short press the Power/Intercom button on one of the M3 units. 5-9 seconds later, the LED on both units will flash blue LED every 2-3 seconds to indicate the pairing is complete.

You have now completed the one-time pairing process between these two units, and the intercom function is ready for use.

Note that the intercom session is normally active following the pairing process. You should press the Power/Intercom button one more time to disconnect the active intercom session if you are not using it.

These units will now automatically pair whenever they are within range of each another.

If for some reason this process is not successful the first time, press the reset button on each unit and perform steps 2 and 3 again.

## Using the M3 Bluetooth Unit Intercom

Opening and closing intercom sessions is as easy as pushing the Power/Intercom button.

If you are using unit A, and your fellow rider or passenger is using unit B, short press the Phone/Intercom button to open the intercom, and you will hear a short beep. It normally takes 3-5 seconds for the intercom session to open. If you are listening to music, the music will be paused (Image 10A, 10B).

**Image 10A  
Rider-to-Rider**

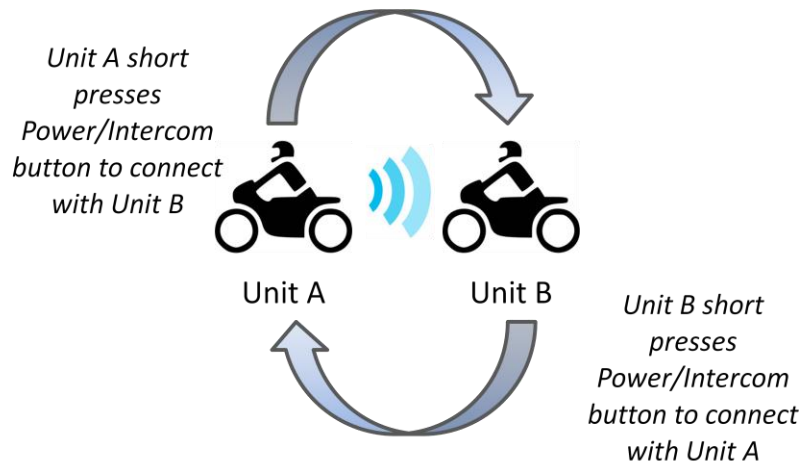

**Image 10B  
Rider-to-Passenger**

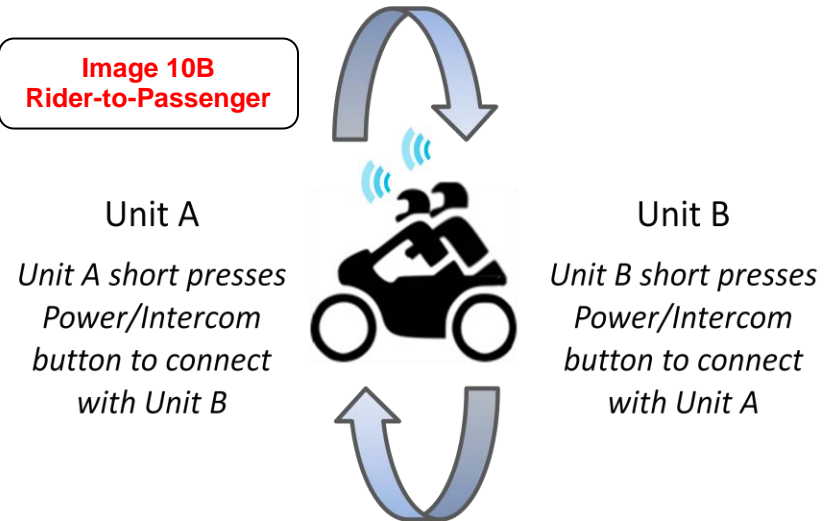

The intercom supports full duplex communication, similar to a phone call. This means both users can speak and listen at the same time.

To end the intercom session, you simply short press the Phone/Intercom button again. You will hear a longer beep which confirms the button press.

Either person can initiate or end the intercom session by pressing the Phone/Intercom button.

Note that phone calls have the highest priority and will automatically interrupt the intercom session. Once a call is complete, the intercom session will resume.

## HELPFUL HINT

The M3 unit battery life can be maximized by closing active intercom sessions when not in use.

### Pairing a Third M3 Bluetooth Unit

The first set of Neckmike M3 Bluetooth units may be paired with a third unit for full duplex communication over Bluetooth. For example, the first two units may be worn by a rider and passenger, and the third unit is worn by a riding buddy. Note that even when three M3 units are paired, intercom sessions are always made between two units at a time.

The third M3 unit is paired in the same way as the first two units. It may be helpful to label each unit A, B, or C during the pairing process. To pair the third device (unit C) you will first pair units A and B, and then pair unit A to unit C, followed by unit B to unit C.

**To pair unit A to unit C**, make sure unit B is powered off during the pairing process.

1. Press the reset button on each unit (< 1 second).
2. Press and hold the Power/Intercom button (marked with a motorcycle icon) on both units for approximately 10 seconds until the LED flashes red and blue, then release. (Note that the LED will turn blue while you continue to hold the button, prior to flashing red and blue). The units are now in pairing mode.
  - a. If you do not get the unit into pairing mode on the first try (and the LED is flashing blue every two seconds to indicate the power is on), press the reset button to turn the power off and repeat this step.

3. With the LED flashing red and blue, short press the Power/Intercom button on one of the M3 units. 5-9 seconds later, the LED on both units will flash blue LED every 2-3 seconds to indicate the pairing is complete.

You have now completed the one-time pairing process between these two units, and the intercom function is ready for use. Note that the intercom session is normally active following the pairing process. You should press the Power/Intercom button one more time to disconnect the active intercom session if you are not using it.

**To pair unit B to unit C**, follow the same steps, with unit A powered off during the pairing process.

Once all three M3 units have been paired, a short press on the Power/Intercom button will open an intercom session with the last unit paired or communicated with, and is accompanied by a short beep tone in the headset. A long press on the Power/Intercom button (approximately 2 seconds) will open an intercom session with the other paired unit, and is accompanied by a double “du-du” tone in the headset.

It is easy to know which unit you will contact with a short Phone/Intercom button press by remembering which last unit you connected with. A short Phone/Intercom button press will always connect with the unit you last spoke to regardless of whether you initiated or received the previous intercom session, and regardless of whether you initiated the previous session with a short or long button press.

A long button press during an active intercom session will close the current session and open a session with the other paired unit.

If the intercom connection is not successful, you will hear a longer low beep, which indicates the intercom connection cannot be made. This can happen if the other party is on an active call, an active intercom session with a different user, is out of range or their unit is not powered on.

### **Pairing with a GPS Navigation Device**

If you are using a Bluetooth-enabled GPS device which supports audio functions, first pair your mobile phone to the GPS, and then pair the GPS to the M3 unit as a headset. This will allow you to hear navigation voice prompts with the Neckmike headset, while using the GPS screen to accept or reject phone calls.

The M3 unit should be powered off to begin.

1. Turn on your GPS and make sure the Bluetooth function is activated in the GPS menu settings.
2. From the GPS device menu, scan for nearby Bluetooth devices to pair with your mobile phone. (Consult your GPS Owner's Manual for more information).
3. After following the GPS device instructions to successfully pair with your mobile phone, follow the GPS device menu instructions to pair with the M3 unit as a headset.
4. Press the reset button on the M3 Bluetooth unit (< 1 second).
5. Press and hold the M3 unit Power/Intercom button approximately 10 seconds until the LED flashes red and blue. The M3 unit will now be discoverable by the GPS, and will appear as "Motor Phone" in the mobile GPS menu.
6. When the M3 unit is discovered, select "Motor Phone" in the GPS device menu to pair. If the GPS asks for a PIN or password, enter 0000 (four zeros).

Your GPS should confirm that the pairing has succeeded.

The M3 and the GPS device should automatically connect each time they are powered on and within range (~10 m).

If the pairing process is not completed within two minutes, the M3 unit will return to standby mode with a quick flashing blue LED every 2-3 seconds.

Note that GPS units with built-in music functions (ex. Garmin zumo 660, 665, 550) become the audio source when paired to the M3, and you cannot use a different A2DP music source over Bluetooth while paired to the GPS. However, you may hardwire a different audio source with the included 2.5 mm to 3.5 mm audio cable if desired.

### **Pairing with an MP3 Player**

The Neckmike M3 headset may be paired with an MP3 player which supports the A2DP stereo Bluetooth profile. Please consult your MP3 player Owner's Manual to see if your device supports A2DP.

The instructions for pairing the M3 to an MP3 player are similar to a mobile phone or GPS:

1. Turn on your MP3 player and make sure the Bluetooth function is activated in the MP3 player menu settings
2. From your MP3 player, scan for nearby Bluetooth devices. (Consult your MP3 device Owner's Manual for more information).
3. Press the reset button on the M3 Bluetooth unit (< 1 second).
4. Press and hold the M3 unit Power/Intercom button approximately 10 seconds until the LED flashes red and blue. The M3 unit will now be discoverable by the MP3

player, and will appear as “Motor Phone” in the music player menu.

5. Select “Motor Phone” in the device menu to pair. If it asks for a PIN or password, enter 0000 (four zeros).

Your MP3 player should confirm that the pairing has succeeded.

The M3 and the MP3 device should automatically connect each time they are powered on and within range (~10 m).

If the pairing process is not completed within two minutes, the M3 unit will return to standby mode with a quick flashing blue LED every 2-3 seconds.

Note: The Neckmike M3 unit can also receive audio from non-Bluetooth enabled MP3 players and other audio sources via the included 2.5 mm to 3.5 mm audio cable. This audio has the lowest priority and will be superseded by active phone calls, intercom sessions or GPS prompts.

## Mounting the M3 Bluetooth Unit

The M3 Bluetooth unit is designed to be mounted onto the left side of a helmet. The clamp mount is attached between the helmet’s outer shell and inner padding. The rectangular plate is inserted on the inside of the helmet shell and affixed with screws to the oval-shaped clip which rests on the outside of the helmet shell (Image 11).

Image 11



Once the helmet clip is in place, the M3 unit attaches to the bracket by inserting lining up the mounting tabs on the back of the M3 unit into the grooves in the bracket until it “clicks” firmly into place (Image 12).

Image 12



To release the unit from the bracket, press on the tab at the bottom of the mounting bracket and gently slide the M3 unit upwards.

The Neckmike is attached to the M3 Bluetooth unit via the coiled extension cable that is included in the package. Be certain that the cable is fully inserted into the 3.5mm port on the M3 Bluetooth unit, otherwise the Neckmike will not function properly and the audio may sound distorted.



To use the M3 Bluetooth unit without a helmet, an accessory arm band is available to attach the M3 unit to the user's arm. Go to [www.neckmike.us](http://www.neckmike.us) for more information or to purchase.

## Support

For additional information please visit our website at [www.neckmike.us](http://www.neckmike.us)

You can also reach us at: [support@neckmike.us](mailto:support@neckmike.us)

## Notifications

### Battery Warning

If these guidelines are not followed, the internal lithium-ion polymer battery may experience a shortened life span or may present a risk of damage to the M3 Bluetooth device, fire, chemical burn, electrolyte leak, and/or injury.

- Do not attempt to remove the non-user-replaceable battery.
- Do not leave the M3 unit exposed to a heat source or in a high temperature location.
- Do not puncture or burn the device or battery.
- Do not operate the device outside of the following temperature range: -20°C to 55°C (-4°F to 131°F)
- When storing the device for an extended time, keep within the following temperature range: 0°C to 25°C (32°F to 77°F)
- Contact your local waste disposal department for proper device / battery disposal in accordance with relevant local laws and regulations

## Declaration of Conformity- Bluetooth®

The Product is compliant with and adopts the Bluetooth specification 2.1 and has successfully passed all interoperability tests that are specified in the Bluetooth® specification. However, interoperability between the device and other Bluetooth®-enabled products is not guaranteed.

## FCC Compliance

This equipment has been tested and found to comply with the limits for a Class B digital device, pursuant to part 15 of the FCC rules. Operation is subject to the following conditions: (1) this device may not cause harmful interference, and (2) this device must accept any interference received, including interference that may cause undesired operation.

These limits are designed to provide reasonable protection against harmful interference in a residential installation. This equipment generates, uses, and can radiate radio frequency energy and may cause harmful interference to radio communications if not installed and used in accordance with the instructions. However, there is no guarantee that interference will not occur in a particular installation. If this equipment does cause harmful interference to radio or television reception, which can be determined by turning the equipment off and on, the user is encouraged to try to correct the interference by one of the following measures:

- Reorient or relocate the receiving antenna
- Increase the separation between the equipment and the receiver.
- Connect the equipment into an outlet that is on a different circuit from the M3 unit
- Consult the dealer or an experienced radio/TV technician for help.

This product does not contain any user-serviceable parts. Repairs should only be made by Neckmike USA. Unauthorized repairs or modifications could result in permanent damage to the equipment, and void your warranty and your authority to operate this device under Part 15 regulations.

### **Copyright**

All rights reserved. The content of this User Guide may not be copied, in whole or in part, without the written consent of Neckmike USA and is protected by copyright laws.

### **IMPORTANT SAFETY INFORMATION**

Neckmike USA (the “Company”) notifies you that your complete and undivided attention is required when using the Neckmike M3 Bluetooth series communication system (the “Product”). Failure to avoid potentially hazardous situations could result in serious injury or even death. The Company encourages you to take all necessary precautions and remain alert to your surroundings including traffic, weather, road conditions and terrain. It is best to pull over and stop in a safe and legal manner away from traffic prior to activating or deactivating the Product or initiating or receiving any calls. Do not perform any Bluetooth pairing while riding.

The User Guide is intended to cover technical capabilities of the Product and should not be interpreted as encouraging the operation of the Product in any manner that is unsafe or prohibited by law. Always exercise due caution when using this Product and obey all relevant traffic laws.

Do not become distracted by the Product while operating any vehicle. Do not operate the Product if it is unsafe to do so.

In some regions or states, the use of headphones or helmet audio is restricted or prohibited. Familiarize yourself with all laws and regulations that apply to your region before using the Product and remember that compliance with all laws and regulations is the user’s responsibility. Use the Product while operating your vehicle only where and how permitted by the applicable law.

The AMA maintains a helpful resource of motorcycle laws by state: <http://www.americanmotorcyclist.com/Rights/State-Laws.aspx>

Use care when installing the Product so that the Product is secure.

## Limited Warranty

This Neckmike product is warranted to be free from defects in materials or workmanship for one year from the date of purchase. Within this period, Neckmike USA will, at its sole discretion, repair or replace any components that fail in normal use. Such repairs or replacement will be made at no charge to the customer for parts or labor, provided that the customer shall be responsible for any shipping cost. This warranty does not apply to: (i) cosmetic damage, (ii) consumable parts such as batteries, unless product damage has occurred due to a defect in materials or workmanship; (iii) damage caused by accident, abuse, misuse, water, flood, fire, or other acts of nature or external causes; (iv) damage caused by service performed by anyone who is not an authorized service provider of Neckmike USA; or (v) damage to a product that has been modified or altered without the written permission of Neckmike USA.

In addition, Neckmike USA reserves the right to refuse warranty claims against products or services that are obtained and/or used in violation of the laws of any country.

THE WARRANTIES AND REMEDIES CONTAINED HEREIN ARE EXCLUSIVE AND IN LIEU OF ALL OTHER WARRANTIES EXPRESS, IMPLIED, OR STATUTORY, INCLUDING ANY LIABILITY ARISING UNDER ANY WARRANTY OF MERCHANTABILITY OR FITNESS FOR A PARTICULAR PURPOSE, STATUTORY OR OTHERWISE. THIS WARRANTY GIVES YOU SPECIFIC LEGAL RIGHTS, WHICH MAY VARY FROM STATE TO STATE OR REGION. IN NO EVENT SHALL NECKMIKE USA BE LIABLE FOR ANY INCIDENTAL, SPECIAL, INDIRECT OR CONSEQUENTIAL DAMAGES, INCLUDING, WITHOUT LIMITATION, DAMAGES TO PROPERTY, TRAFFIC FINES OR CITATIONS, WHETHER RESULTING FROM THE USE, MISUSE OR INABILITY TO USE THE PRODUCT OR FROM DEFECTS IN THE PRODUCT. SOME STATES DO NOT ALLOW THE EXCLUSION OF INCIDENTAL OR CONSEQUENTIAL DAMAGES, SO THE ABOVE LIMITATIONS MAY NOT APPLY TO YOU.

Neckmike USA retains the exclusive right to repair or replace (with a new or remanufactured replacement product) the device or offer a full refund of the purchase price at its sole discretion. SUCH REMEDY SHALL BE YOUR SOLE AND EXCLUSIVE REMEDY FOR ANY BREACH OF WARRANTY.

To obtain warranty service, contact Neckmike USA for shipping instructions and a return authorization number. You must securely package the unit and include a copy of the original sales receipt, which is required as the proof of purchase for warranty repairs.



Neckmike USA  
18460 S. Ridgeview Road  
Olathe, KS 66062  
USA

[www.neckmike.us](http://www.neckmike.us)